

# EASY ARM™ INTELLIGENT LIFTING ARM: THE BRAINS OF A G-FORCE™ IN THE BODY OF A JIB

Your precision lifting applications just got easier, thanks to **EASY ARM™** Intelligent Lifting Arm, the newest addition to Gorbel's family of G-Force™ Intelligent Assist Devices. We took our patented G Force™ lifting technology and processor controlled servo-drive system and integrated them into an ergonomic articulating jib design.

## The Smarter Way to Lift

Our G-Force™ technology gives you the best of both worlds: the responsiveness and the flexibility of a human operator, plus the power of a machine. More precise than hoists, more responsive than air balancers, G-Force™ technology integrated in the EASY ARM™ design improves safety, productivity and quality:

- Provides unparalleled precision at speeds up to 150 fpm.
- Acts as an extension of the operator's arm.
- Makes your work force more productive by increasing efficiency and enabling them to easily perform complex tasks.

## Applications

This versatile new design is ideal for lifting applications that involve:

- Reaching into a work cell or around obstructions
- Rapid changes in direction
- Loading/unloading machined parts
- Moving products around a work cell
- Palletizing

Go to [www.gorbel.com/gforce/easyarm.asp](http://www.gorbel.com/gforce/easyarm.asp) for animations of Easy Arm™ at work.

## Flexible and Convenient

### *No Foundation Required*

Easy Arm™ doesn't require a foundation. Its simple 4-bolt hole pattern means you can put it anywhere you want. You don't need to pour expensive foundations or make costly major modifications to existing plant equipment.

### *Versatile Design*

The Easy Arm™ has adjustable tension of both arms to fine tune its rotation performance. Plus, it pivots in two places on the boom for easier access to hard to reach places.



*This manufacturer uses the G-Force™ Easy Arm for a wide range of assembly applications.*

*Easy Arm's™ optional Float Mode function allows operators to perform precision tasks with their hands on the load itself for maximum control.*



### *Cost Effective*

Easy Arm™ is more cost effective for moving loads in one work cell than adding a work station bridge crane.

### *Easy Installation*

The Easy Arm™ is delivered pre-assembled. To install, simply bolt the mast of the Easy Arm™ to any 6" reinforced floor. Then raise the arm, adjust using integrated leveling device, and apply power. In no time, you are up and running.

### *Easy to Move*

- The Easy Arm™ is a self-contained unit. That means operators don't have the added physical strain of moving a complete bridge and/or trolley.
- The actuator is mounted on the pivot, not on the arm, making the arm lightweight and easy to move.

# Performance Characteristics

Capacity	150 lbs	70 kg
Maximum Lifting Speeds	150 FPM, unloaded 125 FPM, 150# load	46 MPM, unloaded 38 MPM, 150# load
Degree of Rotation	Primary Arm rotates 375° Secondary Arm pivots 270° (6' span) or 315° (8' and 10' spans)	
Power Requirements	220 Volt - Single Phase - 50 Hz or 60 Hz	

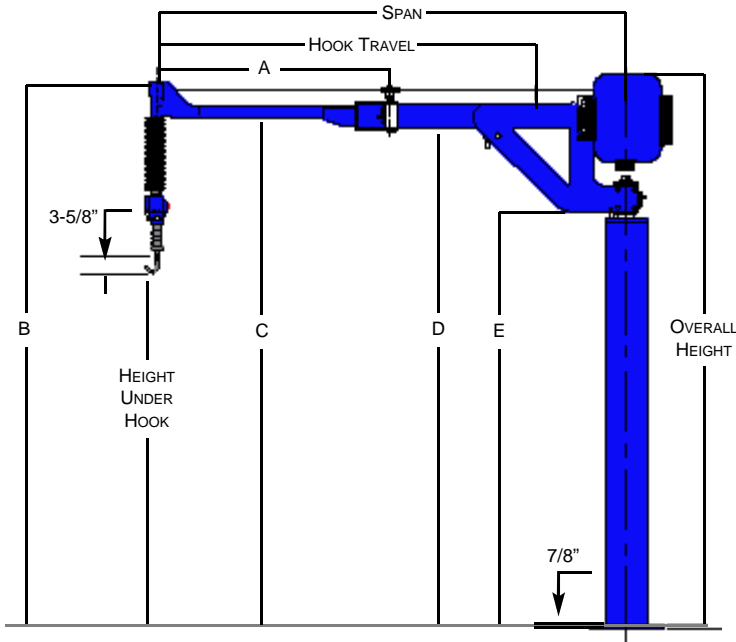

**HOOK TRAVEL:**  
SHADED AREA INDICATES  
HOOK COVERAGE

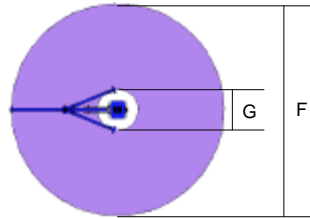

**BOLT PATTERN:**

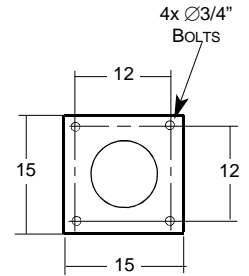

### Application Notes:

- When sizing the Easy Arm, it is critical to select the optimal span and HUH for your application. As with any crane system, choose the *minimum* span and HUH needed to maximize ease of movement.
- An Optional Portable Base is available. Contact us at (585) 924-6262 or (800) 821-0086 for information.

HEIGHT UNDER HOOK	SPAN	WEIGHT	OVERALL HEIGHT	A	B	C	D	E	F	G	Hook TRAVEL
6' (1829 mm)	6' (1829)	484# 220 kg	106-7/8" (2715)	36" (914)	105-1/4" (2673)	98-1/16" (2491)	95-3/4" (2432)	78-3/4" (2000)	144" (3658)	55" (1397)	44-1/2" (1130)
	8' (2438)	501# 227 kg		48" (1219)					192" (4877)	36-7/8" (937)	77-9/16" (1970)
	10' (3048)	518# 235 kg		60" (1524)					240" (6096)	46" (1168)	97" (2464)
8' (2438 mm)	6' (1829)	529# 240 kg	130-7/8" (3324)	36" (914)	129-1/4" (3283)	122-1/16" (3100)	119-3/4" (3042)	102-3/4" (2610)	144" (3658)	55" (1397)	44-1/2" (1130)
	8' (2438)	546# 248 kg		48" (1219)					192" (4879)	36-7/8" (937)	77-9/16" (1970)
	10' (3048)	564# 256 kg		60" (1524)					240" (6096)	46" (1168)	97" (2464)

■ U.S. System    ■ (Metric System)  
All values in parentheses are in millimeters